



T.L.P.NO. 57/2021/H



CAUTION:
THE LAYOUT PROPOSALS ARE PROCESSED AS PER EXISTING LAYOUT RULES VIDE G.O.Ms.No.62 MA Dt.28/01/1970 IN THE STRENGTH OF MA&UD DEPARTMENT GOVT.OF TELANGANA VIDE MEMO NO.10788/plg/III/2019, Dt.11/12/2019.

EXTRACT OF GIRIGETPALLY VILLAGE MAP
EXTRACT OF VIKARABAD MASTER PALN

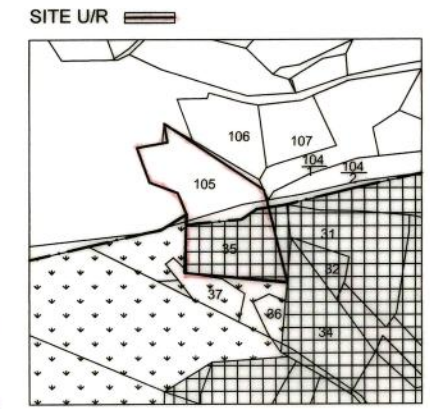

REFERENCE:

| | | |
|--------------------------------------|--|----------------|
| LAYOUT BOUNDARY | | |
| EXISTING ROADS | | |
| PROPOSED ROADS | | |
| LAYOUT AREA | | Ac.23.59 cents |
| SITE RESERVED FOR OPEN SPACE (10.0%) | | Ac.2.359 cents |
| ROADS AREA (33.62%) | | Ac.7.932 cents |
| NUMBER OF PLOTS | | 277 |

More than Expect

SHATHABDHI
TOWNSHIPS PVT. LTD.
AN ISO 9001-2015 CERTIFIED COMPANY
ASIA'S GREATEST BRAND 2017
WORLD'S GREATEST BRAND 2018-19

VIKARABAD MUNICIPALITY
TECHNICAL LAYOUT PATTERN FOR RESIDENTIAL PLOTS IN Sy.No's 35/P OF ANANTHAGIRIPALLY (V) AND 105/P OF GIRIGETPALLY VILLAGE , VIKARABAD MUNICIPALITY AND DISTRICT.

| | | | | |
|--------|-------|----------|----------|--|
| | | | | |
| A.D.M. | T.P.A | A.D.T.P. | D.D.T.P. | DIRECTOR OF TOWN & COUNTRY PLANNING GOVT. OF TELANGANA, HYDERABAD |

SCALE :- 100 FEET TO AN INCH