

N

CAUTION:-



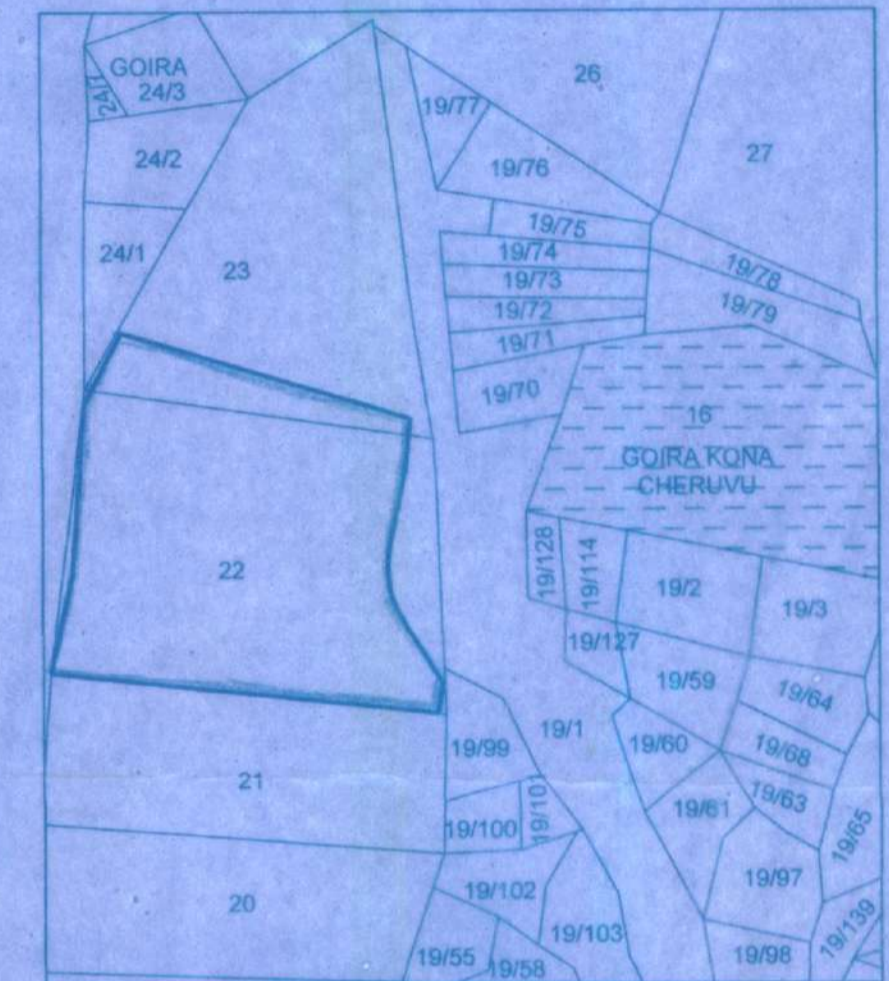

THIS LAYOUT IS LEGALLY VALID ONLY ON ITS RELEASE/ APPROVAL BY THE CONCERNED GRAMPANCHAYAT UNDER SECTION 113(b) TELANGANA PANCHAYAT RAJ ACT 2018 (Act no 5 / 2018 ) AS COMMENCED WIDE G.O.Ms.No.22 PR & RD Dt.18-04-2018 AND UNDER RULE 11 (3)OF G.O.67 PR & RD, Dt: 26-02-2002 ON FULLFILMENT OF ALL LAYOUT CONDITIONS. ANY TRANSACTIONS PRIOR TO THE ABOVE IS ILLEGAL.

EXTRACT OF KOTHAPETA VILLAGE MAP

SITE UNDER REFERENCE : 



REFERENCE:

- LAYOUT BOUNDARY 
- EXISTING ROADS 
- PROPOSED ROADS 
- MORTGAGE AREA 

AREA STATEMENT:

LAYOUT AREA	AC 19.86 CENTS.	96122.40 SQ.YDS.
OPEN SPACE (10%)	AC 1.986 CENTS.	9612.24 SQ.YDS.
ROADS AREA (32.16%)	AC 6.387 CENTS.	30913.08 SQ.YDS.
PLOTTED AREA (58.47%)	AC 11.613 CENTS.	56206.92 SQ.YDS.
MORTGAGE AREA (15.50%) ON PLOTTED AREA (FROM PLOT NO. 1 to 16, 160 to 166 and 177.)	AC 1.80 CENTS.	8712.00 SQ.YDS.
NO. OF PLOTS	202	

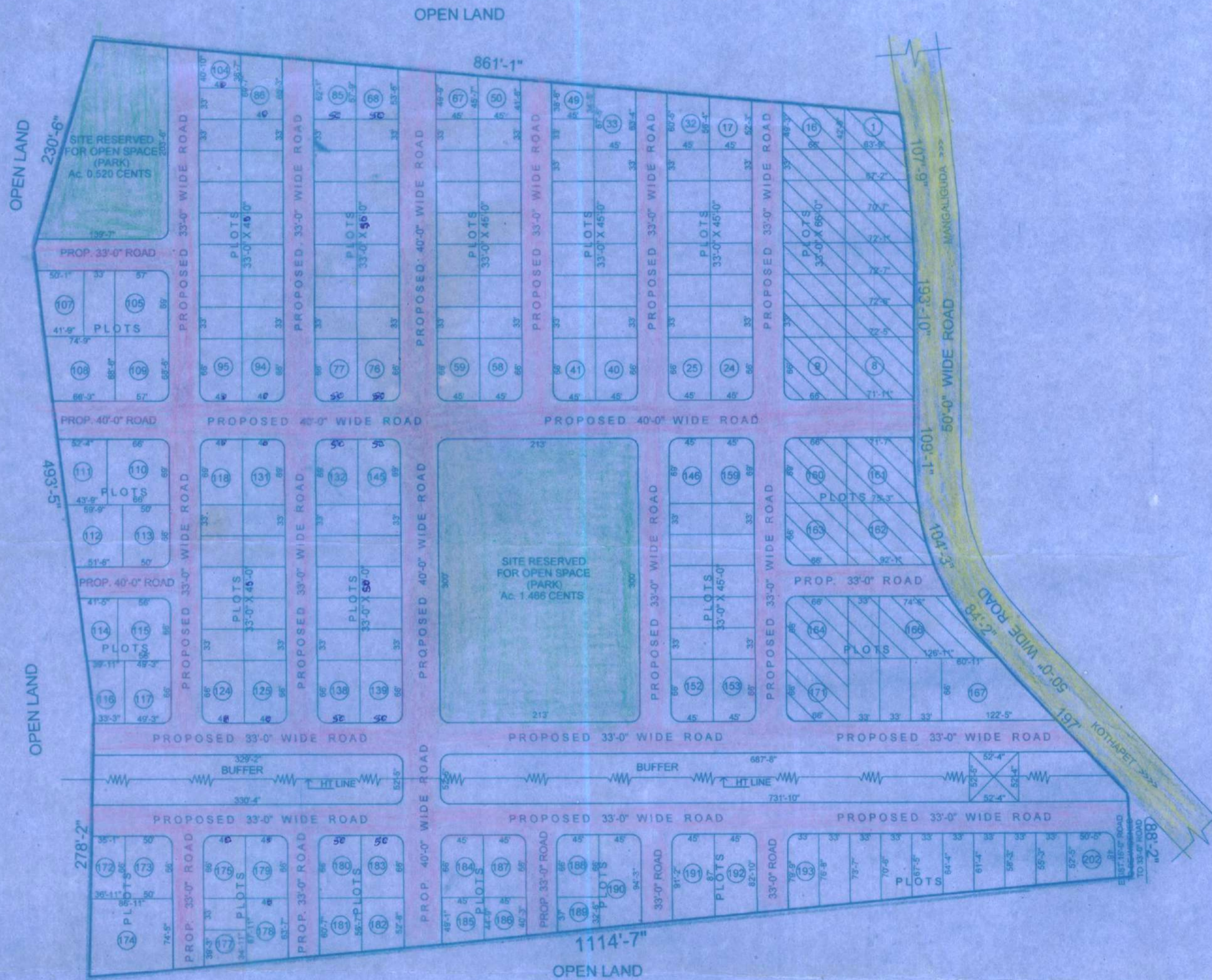

KOTHAPETA GRAMPANCHAYAT

DRAFT TECHNICAL LAYOUT PATTERN FOR RESIDENTIAL PLOTS IN SY.NO's 22/P & 23/P SITUATED AT KOTHAPET (V), KESHAMPET (M), RANGA REDDY DT.

SCALE = 1" : 100'-0"



A.D.M.

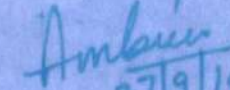

T.P.A.

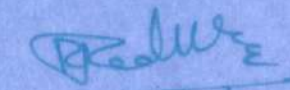

ASST. DIRECTOR



DY. DIRECTOR

  
 B'Arch., M.U.R.P., A.I.T.P.  
 DIRECTOR OF TOWN & COUNTRY PLANNING  
 GOVT. OF TELANGANA, HYDERABAD.