

Silver Springs Grand B

Express Highway @ Keshampet

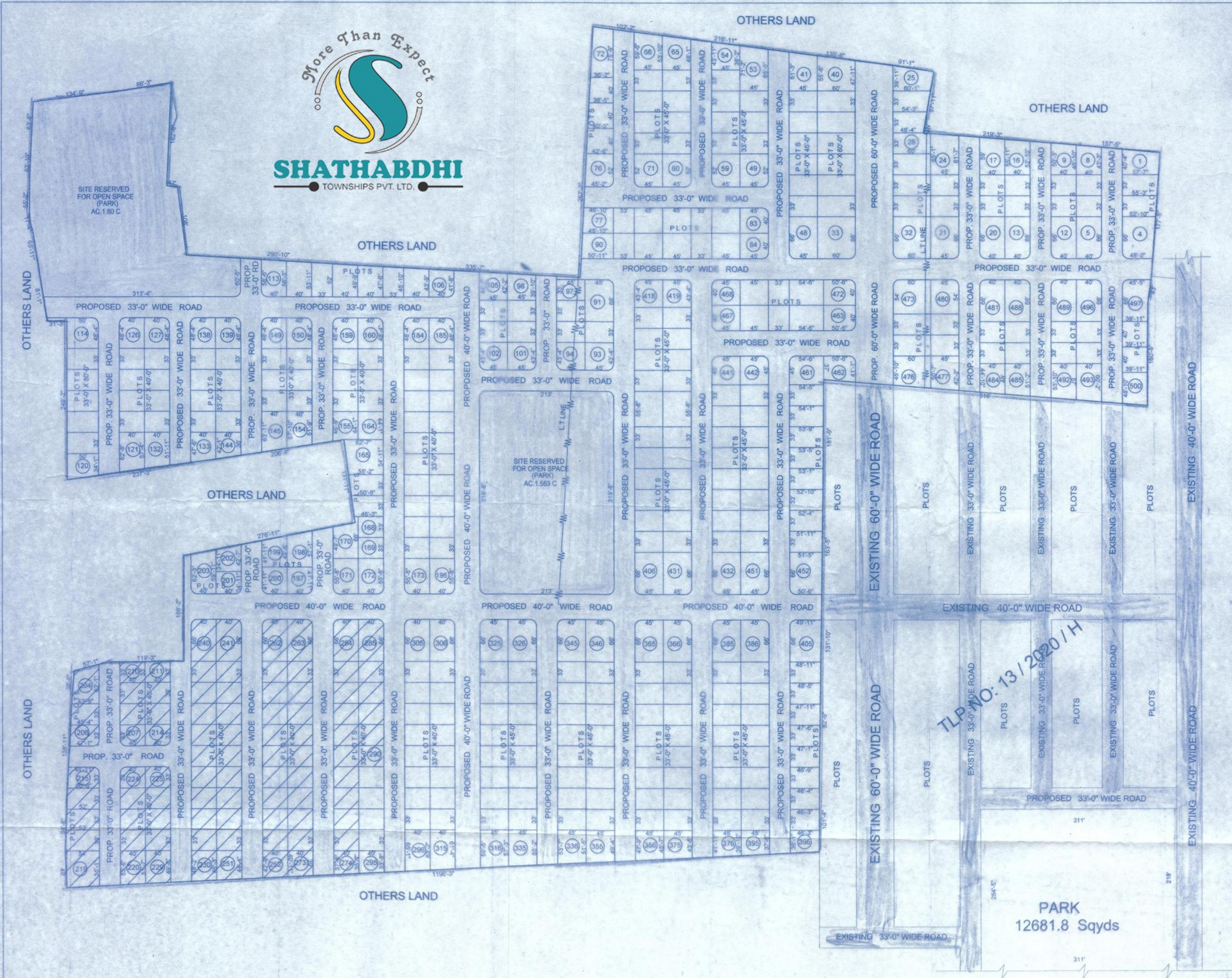

E.P.NO.: 12488/1164/2020/e-panchayat
REF.No.: 1164 OF LEMAMIDI G.P,
T.L.P. No. 292/2020/H



CAUTION:-
THIS LAYOUT IS LEGALLY VALID ONLY ON ITS RELEASE/ APPROVAL BY THE CONCERNED GRAMPANCHAYAT UNDER SECTION 113(b) TELANGANA PANCHAYAT RAJ ACT 2018 (Act no 5 / 2018) AS COMMENCED WIDE G.O.Ms. No.22 PR & RD Dt.18-04-2018 AND UNDER RULE 11 (3)OF G.O.67 PR & RD, DT: 26-02-2002 ON FULLFILMENT OF ALL LAYOUT CONDITIONS. ANY TRANSACTIONS PRIOR TO THE ABOVE IS ILLEGAL.

LEMAMIDI GRAM PANCHAYATH
EXTRACT OF VILLAGE MAP
SITE U/R



REFERENCE:
LAYOUT BOUNDARY
EXISTING ROADS
PROPOSED ROADS
MORTGAGE AREA

AREA STATEMENT:

LAYOUT AREA	AC 33.63 CENTS.	162769.20 SQ.YDS.
OPEN SPACE (10%)	AC 3.363 CENTS.	16276.92 SQ.YDS.
ROADS AREA (31.68%)	AC 10.654 CENTS.	51565.36 SQ.YDS.
PLOTTED AREA (58.32%)	AC 19.613 CENTS.	94926.92 SQ.YDS.
MORTGAGE AREA (15.29%) ON PLOTTED AREA (FROM PLOT NO. 204 TO 290)	AC 3.000 CENTS.	14520.00 SQ.YDS.
NO. OF PLOTS	500	

NOTE:-
THE BUILDING PERMISSION FOR THE PLOT NO.'S 28 TO 32, 94 TO 97 AND 473 TO 476 SHALL NOT BE PERMITTED UNTIL AND UNLESS THE L.T ELECTRICAL LINES ARE SHIFTED ALONG THE PROPOSED ROADS.

LEMAMIDI GRAM PANCHAYATH
DRAFT TECHNICAL LAYOUT PATTERN FOR RESIDENTIAL PLOTS IN SY.NOs. 152/P, 153/P, 156/P, 158/P, 159/P
SITUATED AT LEMAMIDI (V) AND (G.P), KESHAMPET (M), RANGA REDDY DISTRICT.
SCALE - 100 FEET TO AN INCH

19/12/2020
ADM

18/12/2020
T.P.A

16/12/2020
A.D.T.P

19/12/2020
D.D.T.P

21/12/2020
B.Arch, M.U.R.P., A.I.T.P.
DIRECTOR OF TOWN AND COUNTRY PLANNING
GOVT. OF TELANGANA, HYDERABAD.