

C.NO.: 12305/456/2022/H
 REF.No.: 456 OF PS , KISHAN NAGAR G.P.
 T.L.P. No. 64 / 2022 / H



CAUTION:-
 THIS LAYOUT IS LEGALLY VALID ONLY ON ITS RELEASE/ APPROVAL BY THE CONCERNED GRAMPANCHAYAT UNDER SECTION 113(b) TELANGANA PANCHAYAT RAJ ACT 2018 (Act no 5 / 2018) AS COMMENCED WIDE G.O.Ms.No.22 PR & RD Dt.18-04-2018 AND UNDER RULE 11 (3)OF G.O.67 PR & RD, DT: 26-02-2002 ON FULLFILMENT OF ALL LAYOUT CONDITIONS. ANY TRANSACTIONS PRIOR TO THE ABOVE IS ILLEGAL.

KISHAN NAGAR GRAM PANCHAYAT
 EXTRACT OF VILLAGE MAP

SITE U/R

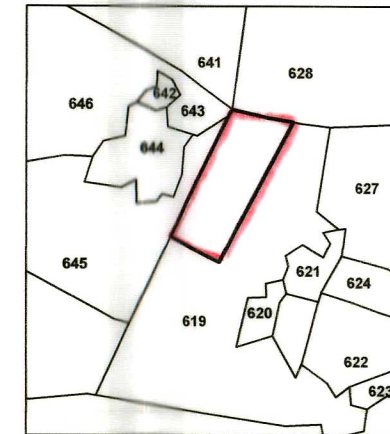

REFERENCE:
 LAYOUT BOUNDARY
 EXISTING ROADS
 PROPOSED ROADS
 MORTGAGE AREA

AREA STATEMENT:

LAYOUT AREA	AC 6.171 CENTS.	29867.64 SQ.YDS.
OPEN SPACE (10%)	AC 0.618 CENTS.	2991.12 SQ.YDS.
ROADS AREA (29.99%)	AC 1.851 CENTS.	8958.84 SQ.YDS.
PLOTTED AREA (60.01%)	AC 3.702 CENTS.	17917.68 SQ.YDS.
MORTGAGE AREA (15.99%) ON PLOTTED AREA (FROM PLOT NO'S 10 TO 12 AND 57 TO 65)	AC 0.592 CENTS.	2865.28 SQ.YDS.
NO. OF PLOTS	65	

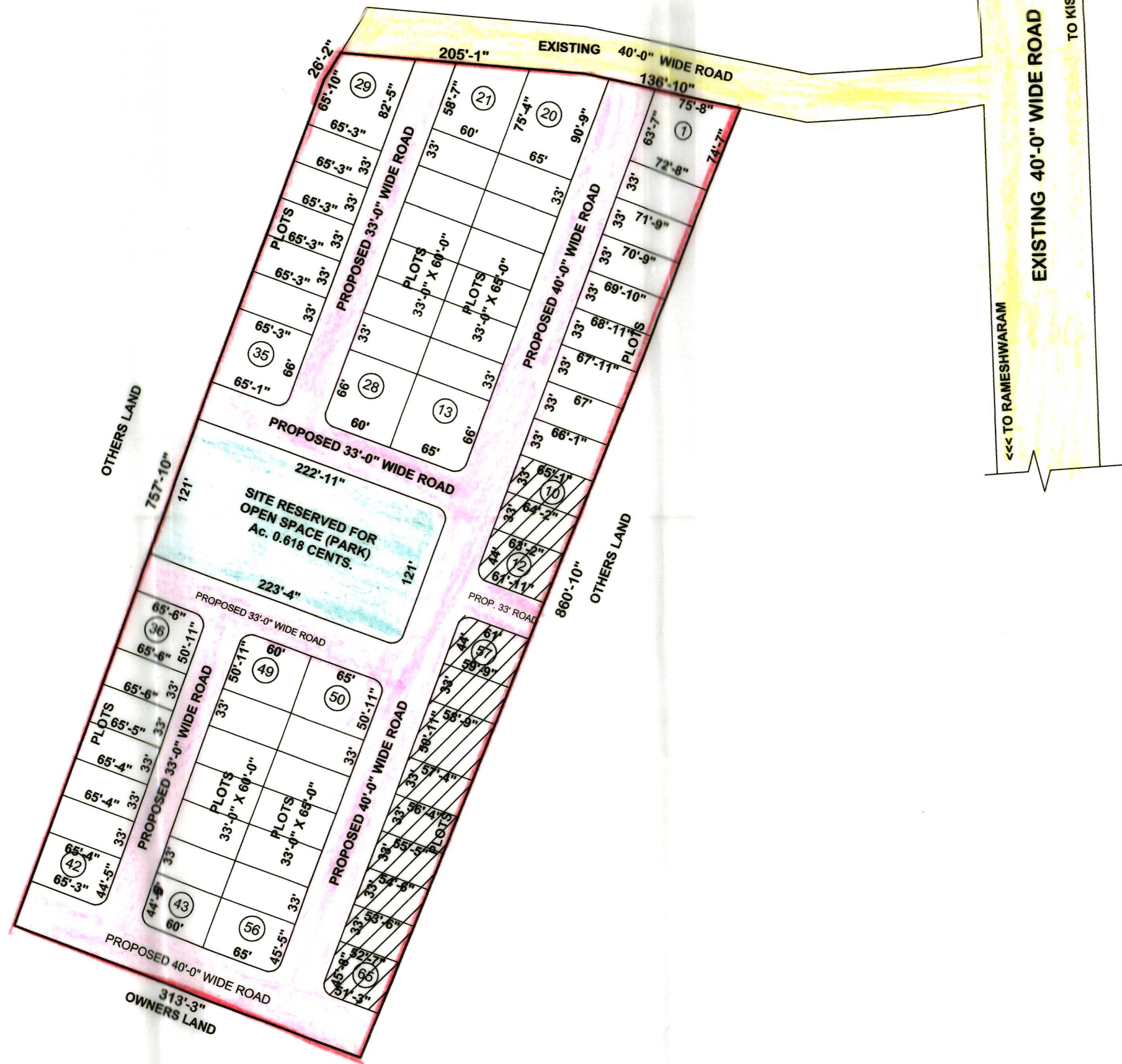

KISHAN NAGAR GRAM PANCHAYATH
 DRAFT TECHNICAL LAYOUT PATTERN FOR RESIDENTIAL PLOTS IN Sy.No.'S619/P SITUATED AT KISHAN NAGAR GRAM PANCHAYAT , FAROOQNAGAR MANDAL, RANGARAEDDY DISTRICT.
 SCALE :- 66 FEET TO AN INCH

2/3/2022
 A.D.M

11/03/2022
 T.P.A.

11/03/2022
 D.D.T.P

11/3/22
 JOINT DIRECTOR

11/3/22
 B.Arch., M.U.R.P., A.I.T.P.
 DIRECTOR OF TOWN & COUNTRY PLANNING
 GOVT. OF TELANGANA, HYDERABAD